

NOT FOR CONSTRUCTION PURPOSES

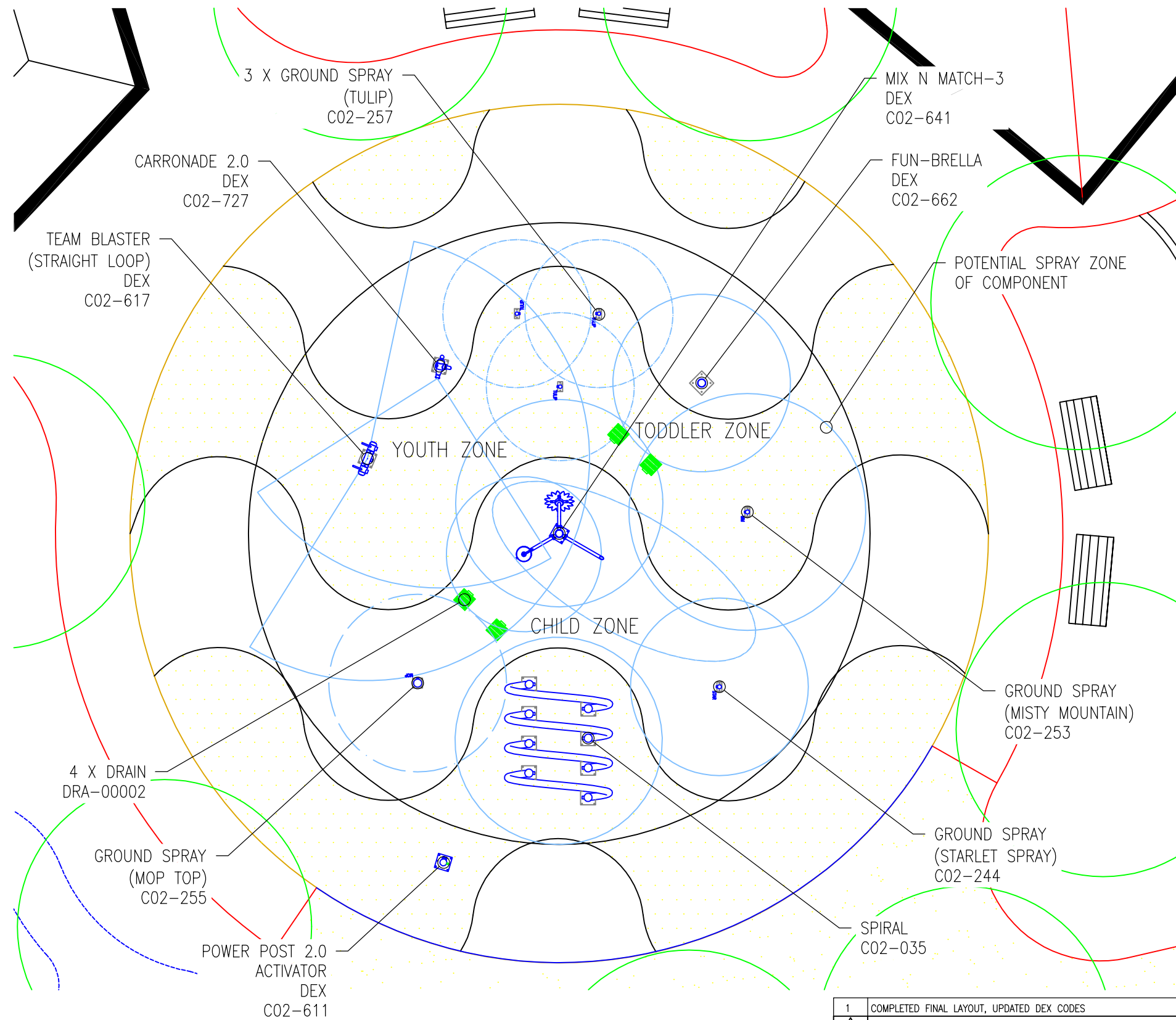

Thatcher, AZ_Jun2912.dwg

29/06/2012 2:56 PM

Waterplay Solutions Corp.

11 x 17 plot

1	COMPLETED FINAL LAYOUT, UPDATED DEX CODES	SN	JUN 29/12
REV	DESCRIPTION	REV'D BY	REV DATE

1451B ELLIS STREET, KELOWNA BC, CANADA V1Y 2A3
 TEL. (250) 712-3393 FAX (250) 861-4814
 EMAIL info@waterplay.com

SCALE: 1/8"=1'
 DRAWN BY: CMW
 DATE: APR 17/12 REV #: 1
 FILE: \PROJECTS\2012\THATCHER
 DWG BY: WATERPLAY SOLUTIONS CORP

DWG NAME: WATERPLAY CONCEPT LAYOUT
 SHEET 1/4
 PROJECT: THATCHER COMMUNITY PARK, AZ

Copyright Material
 All plans & designs at all times remain the property of Waterplay Manufacturing Inc., and cannot be used or reproduced without the written consent of Waterplay.



FOR INFORMATIONAL PURPOSES ONLY. LOCAL LANDSCAPE ARCHITECT, ENGINEER AND/OR APPROPRIATE AUTHORITIES HAVING JURISDICTION MUST COMPLETE ALL PARK LAYOUT, MECHANICAL & ELECTRICAL DESIGN PRIOR TO CONSTRUCTION.

Y COPYRIGHTED MATERIAL REPRESENTED IN THIS DOCUMENT IS NOT THE SOLE PROPERTY OF WATERPLAY SOLUTIONS CORPORATIONS AND DISTRIBUTION SHALL BE CONTROLLED.

Design Services Conditional Release
 The design services provided herein, including but not limited to; water structure layout guide, water supply routing, suggested footing details, construction guidelines, are provided at no charge. Waterplay Solutions Corp. reserves the right to invoice the recipient for these design services in the event genuine Waterplay products are not purchased, and are substituted by products other than those manufactured by Waterplay. The design services provided have an estimated value of \$2000 usd. The recipient of these designs has been made aware of aforementioned conditions.

**NOT FOR CONSTRUCTION
PURPOSES**

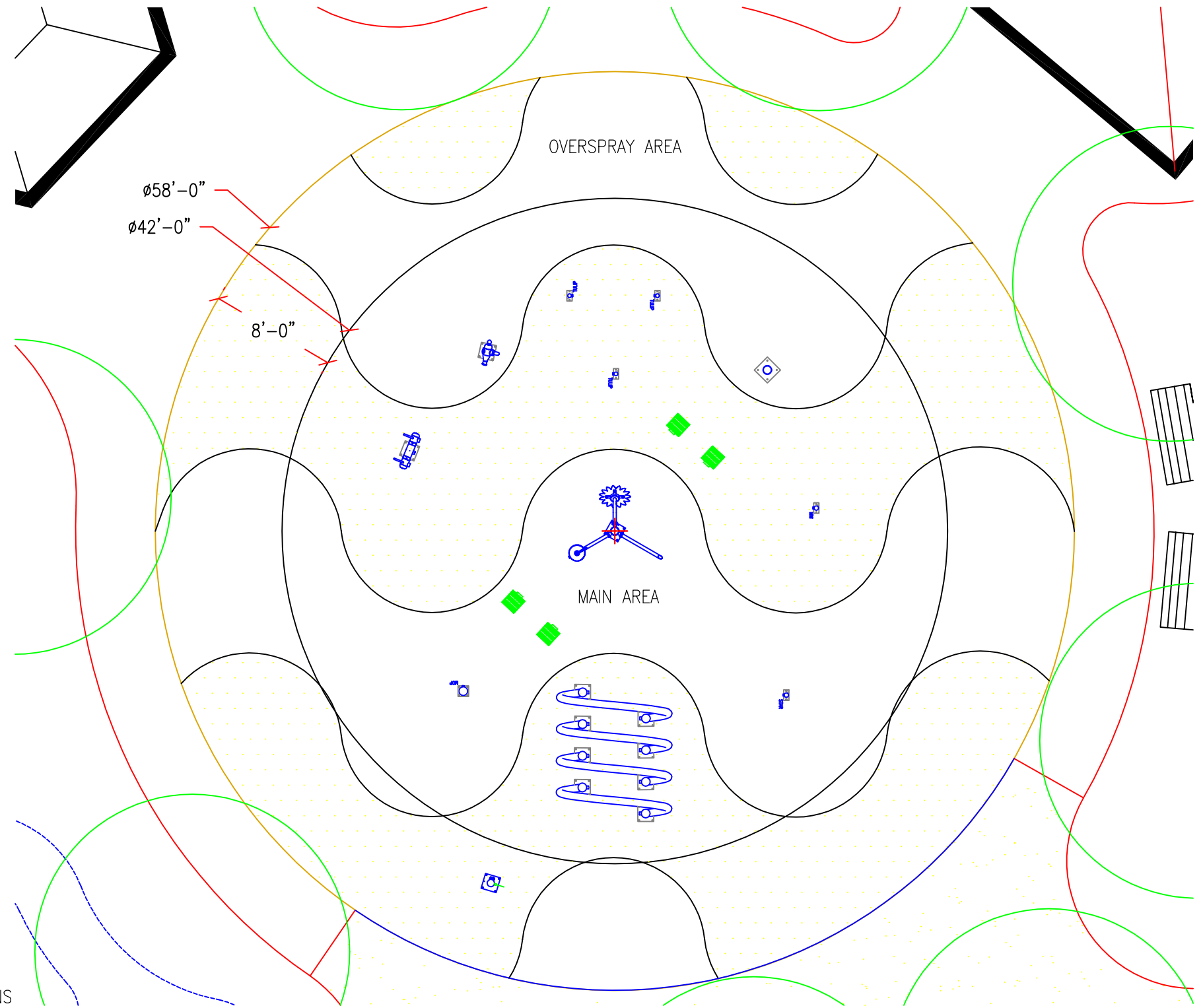

NOTES:

1. MAIN AQUATIC PLAY PAD AREA: 1385 SQUARE FEET
TOTAL AREA, INCLUDING OVERSPRAY ZONE: 2642 SQUARE FEET
2. RECOMMEND 8 TO 10 FOOT OVERSPRAY (PENDING WIND CONDITIONS)
3. GRADE SURROUNDING OUTSIDE PERIMETER LANDSCAPE TO PROVIDE PROPER DRAINAGE AWAY FROM OVERSPRAY PAD
4. SLOPES (INCLUDING MAIN PAD AND OVERSPRAY AREA) TO PROVIDE POSITIVE DRAINAGE TO DRAINS
5. SLAB GRADES SUBJECT TO ENGINEER APPROVAL (NOTE ADA MAX CROSS SLOPE GRADE IS 2%)

Thatcher, AZ_Jun2912.dwg

29/06/2012 2:56 PM

Waterplay Solutions Corp.

11 x 17 plot

1	COMPLETED FINAL LAYOUT, UPDATED DEX CODES	SN	JUN 29/12
REV	DESCRIPTION	REV'D BY	REV DATE

Design Services Conditional Release
The design services provided herein, including but not limited to; water structure layout guide, water supply routing, suggested footing details, construction guidelines, are provided at no charge. Waterplay Solutions Corp. reserves the right to invoice the recipient for these design services in the event genuine Waterplay products are not purchased, and are substituted by products other than those manufactured by Waterplay. The design services provided have an estimated value of \$2000 usd. The recipient of these designs has been made aware of aforementioned conditions.

1451B ELLIS STREET, KELOWNA BC, CANADA V1Y 2A3
TEL. (250) 712-3393 FAX (250) 861-4814
EMAIL info@waterplay.com

SCALE: 1/8":1'
DRAWN BY: CMW
DATE: APR 17/12
REV #: 1
FILE: \PROJECTS\2012\THATCHER
DWG BY: WATERPLAY SOLUTIONS CORP

DWG NAME: WATERPLAY CONCEPTUAL PAD LAYOUT
PROJECT: THATCHER COMMUNITY PARK, AZ

SHEET 2/4

Copyright Material

All plans & designs at all times remain the property of Waterplay Manufacturing Inc., and cannot be used or reproduced without the written consent of Waterplay.



FOR INFORMATIONAL PURPOSES ONLY. LOCAL LANDSCAPE ARCHITECT, ENGINEER AND/OR APPROPRIATE AUTHORITIES HAVING JURISDICTION MUST COMPLETE ALL PARK LAYOUT, MECHANICAL & ELECTRICAL DESIGN PRIOR TO CONSTRUCTION.

COPYRIGHTED MATERIAL REPRESENTED IN THIS DOCUMENT IS NOT THE SOLE PROPERTY OF WATERPLAY SOLUTIONS CORPORATIONS AND DISTRIBUTION SHALL BE CONTROLLED.

NOT FOR CONSTRUCTION PURPOSES

Thatcher, AZ_Jun2912.dwg

29/06/2012 2:56 PM

Waterplay Solutions Corp.

NOTES:

1. ALL DIMENSIONS MEASURED FROM DIMENSION ORIGIN (0,0) TO CENTRE OF FOOTING
2. REFER TO FOOTING DETAILS FOR EACH WATER STRUCTURE
3. LOCATE DRAINS TO PREVENT STANDING WATER
4. GROUND ALL COMPONENTS TOGETHER WITH GROUNDING WIRE AND BASE PLATE GROUNDING LUG

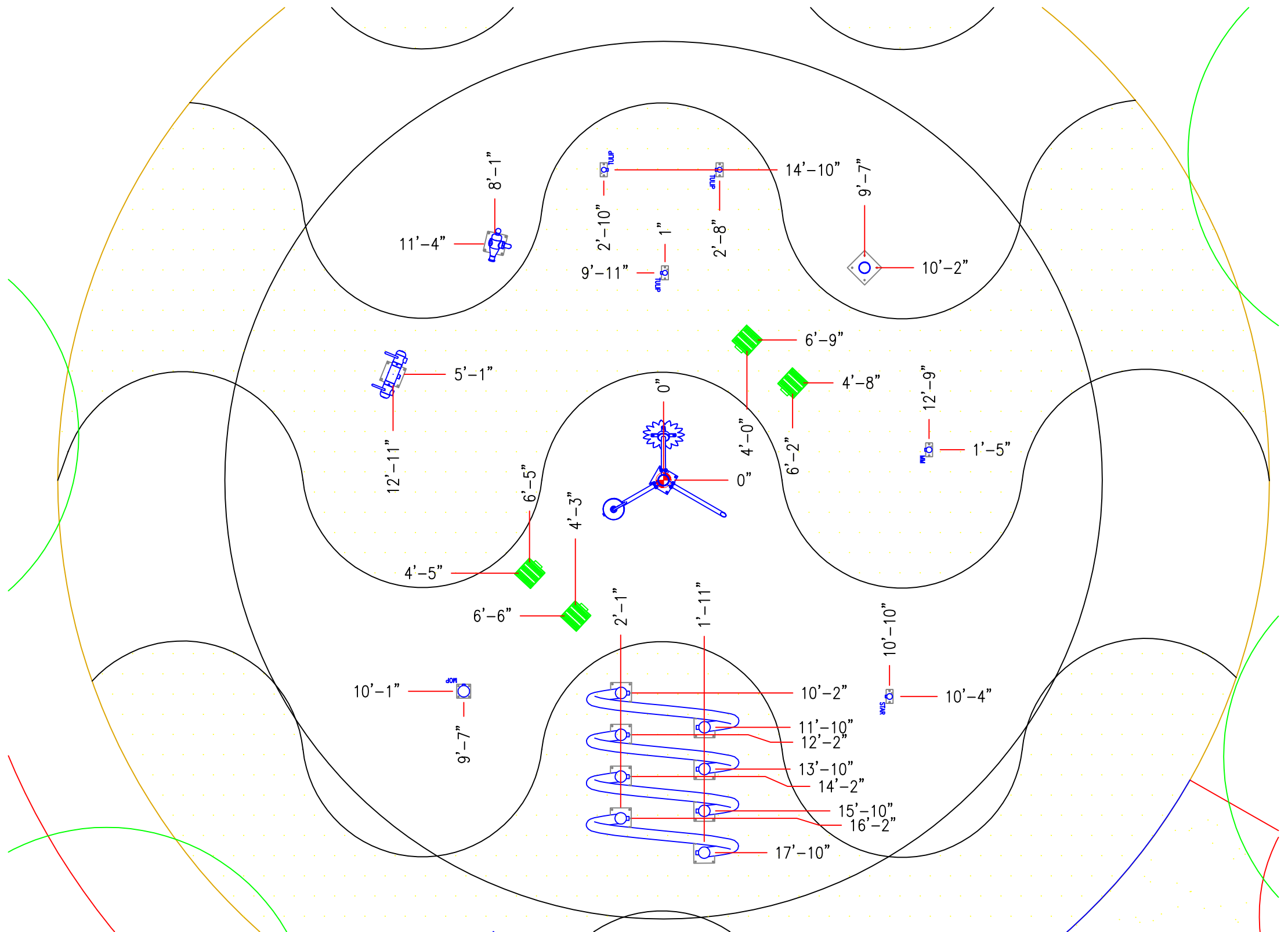

11 x 17 plot

1	COMPLETED FINAL LAYOUT, UPDATED DEX CODES	SN	JUN 29/12
REV	DESCRIPTION	REV'D BY	REV DATE

Design Services Conditional Release
The design services provided herein, including but not limited to; water structure layout guide, water supply routing, suggested footing details, construction guidelines, are provided at no charge. Waterplay Solutions Corp. reserves the right to invoice the recipient for these design services in the event genuine Waterplay products are not purchased, and are substituted by products other than those manufactured by Waterplay. The design services provided have an estimated value of \$2000 usd. The recipient of these designs has been made aware of aforementioned conditions.

1451B ELLIS STREET, KELOWNA BC, CANADA V1Y 2A3
TEL. (250) 712-3393 FAX (250) 861-4814
EMAIL info@waterplay.com

SCALE: 3/16"=1'
DRAWN BY: SN
DATE: JUN 29/12
REV #: 1
FILE: \PROJECTS\2012\THATCHER
DWG BY: WATERPLAY SOLUTIONS CORP

DWG NAME: WATERPLAY COMPONENT PLACEMENT
PROJECT: THATCHER COMMUNITY PARK, AZ

SHEET 3/4
Copyright Material
All plans & designs at all times remain the property of Waterplay Manufacturing Inc., and cannot be used or reproduced without the written consent of Waterplay.

FOR INFORMATIONAL PURPOSES ONLY. LOCAL LANDSCAPE ARCHITECT, ENGINEER AND/OR APPROPRIATE AUTHORITIES HAVING JURISDICTION MUST COMPLETE ALL PARK LAYOUT, MECHANICAL & ELECTRICAL DESIGN PRIOR TO CONSTRUCTION.

COPYRIGHTED MATERIAL REPRESENTED IN THIS DOCUMENT IS NOT THE SOLE PROPERTY OF WATERPLAY SOLUTIONS CORPORATIONS AND DISTRIBUTION SHALL BE CONTROLLED.

VALVE TABLE			COUPLER TYPE: NPT	
VALVE #	COMPONENT NAME	QTY/VALVE	GPM	LINE SIZE FROM MANIFOLD
1	GROUND SPRAY (TULIP)	2	28	1.5 in
2	CARRONADE 2.0 (DEX)	1	6	1.5 in
3	GROUND SPRAY (TULIP)	1	14	1.5 in
4	FUN-BRELLA (DEX)	1	30	1.5 in
5	GROUND SPRAY (MISTY MOUNTAIN)	1	1	1.5 in
6	MIX N MATCH 3 (DEX)	1	12	1.5 in
7	GROUND SPRAY (STARLET SPRAY)	1	7	1.5 in
8	SPIRAL LOOP	1	22	1.5 in
9	GROUND SPRAY (MOP TOP)	1	12	1.5 in
10	TEAM BLASTER ST LOOP (DEX)	1	12	1.5 in

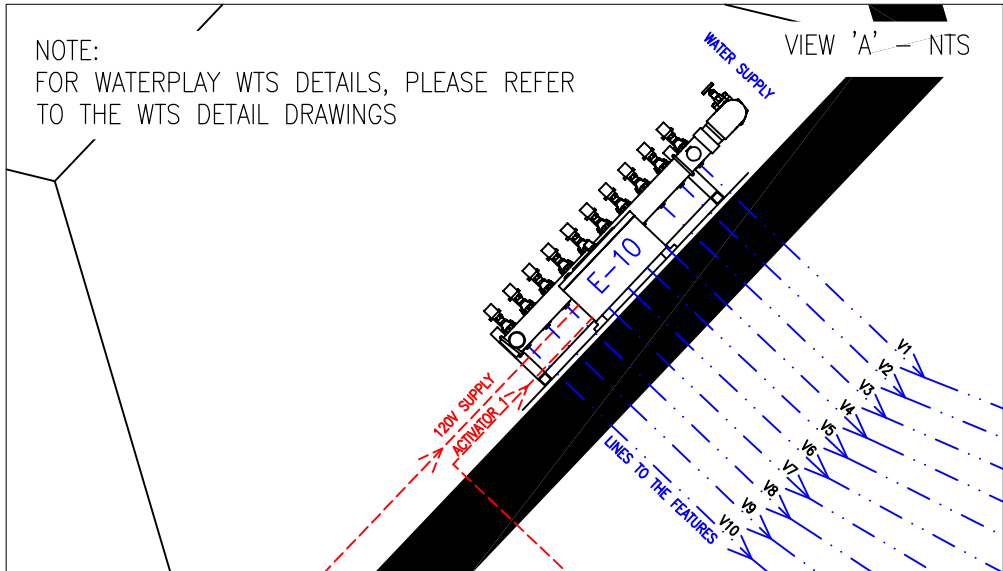
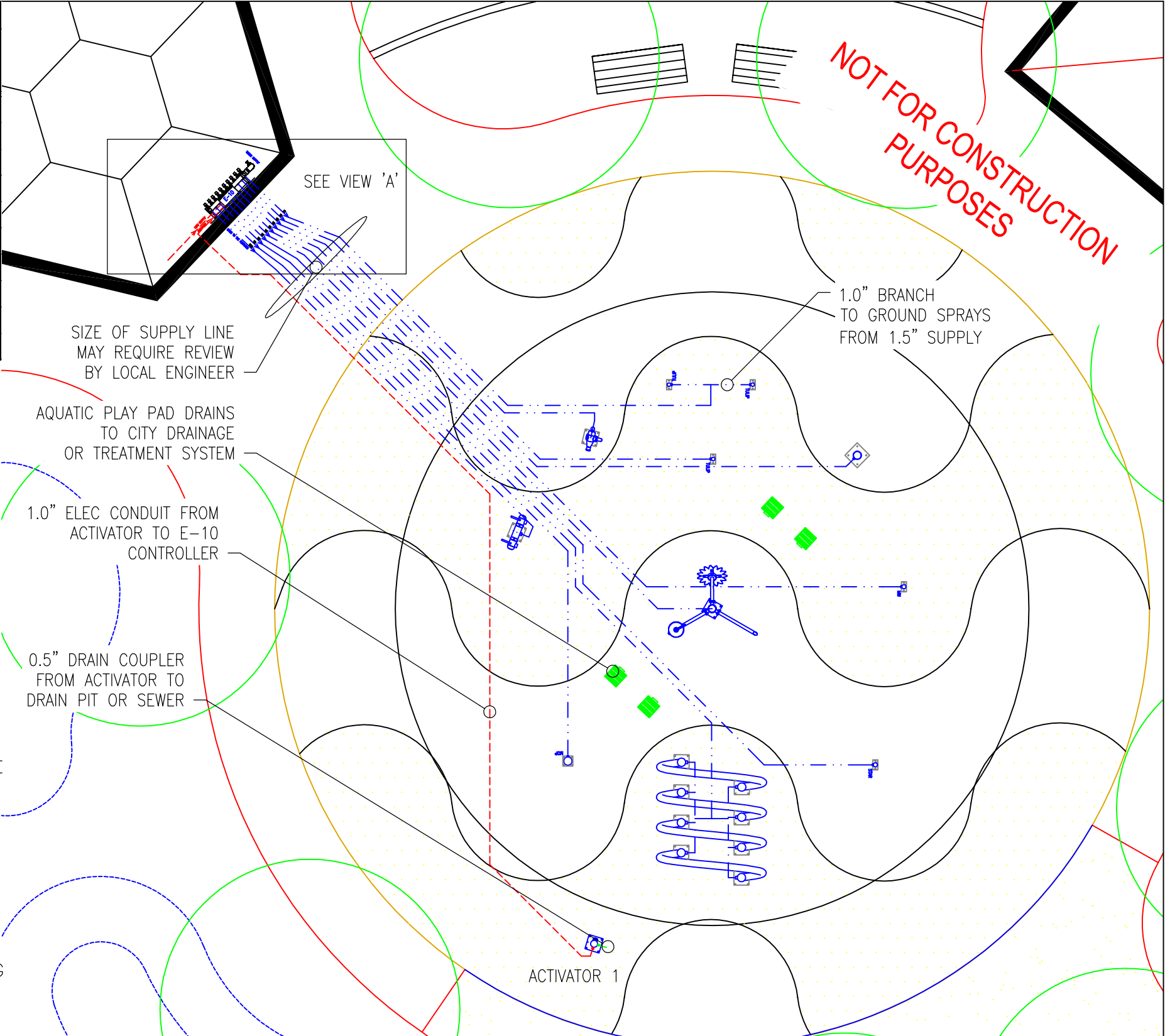

- NOTES:
1. THIS IS A PRELIMINARY SCHEMATIC, SITE PIPING MUST BE DETERMINED AND MEASURED ON-SITE
 2. DESIGN IS BASED ON SCHEDULE 40 OR 80 PVC. APPROVED PIPING TYPE TO BE DETERMINED BY LOCAL AUTHORITIES
 3. WATER LINES MUST HAVE POSITIVE DRAINAGE FROM AQUATIC PLAY FEATURES TO VAULT OR LOW POINT FOR WINTERIZING AND MAINTENANCE.
 4. PROVIDE PRESSURE CONTROL AT MAIN WATER SOURCE UPSTREAM FROM MANIFOLD VALVES
 5. VAULT SHALL BE EASILY ACCESSIBLE BY STAFF AND SECURED FROM PUBLIC
 6. WATER AT NOZZLES SHOULD BE AT LOW PRESSURE (2-30 PSI TYPICAL)
 7. GPM IN ABOVE TABLE IS FOR LOW FLOW NOZZLES @ 15 PSI NOZZLE PRESSURE
 8. E-10 CONTROLLER CONFIGURED FOR TREATED WATER SUPPLY
 9. THE SIZE OF RECIRCULATED SYSTEM WILL VARY DEPENDING ON VALVES REQUIRED AND HOLDING TANK REGULATIONS (TO BE DETERMINED BY OWNER, FROM LOCAL HEALTH AUTHORITIES)
 10. PROJECT SPECIFIC TREATED SYSTEM DESIGNS MAY NOT BE EXACTLY AS SHOWN

Thatcher, AZ_Jun2912.dwg
29/06/2012 2:56 PM
Waterplay Solutions Corp.

11 x 17 plot

1	COMPLETED FINAL LAYOUT, UPDATED DEX CODES	SN	JUN 29/12
REV	DESCRIPTION	REV'D BY	REV DATE

1451B ELLIS STREET, KELOWNA BC, CANADA V1Y 2A3
 TEL. (250) 712-3393 FAX (250) 861-4814
 EMAIL info@waterplay.com

SCALE: 1/8"=1'
 DRAWN BY: SN
 DATE: JUN 29/12
 REV #: 1
 FILE: \PROJECTS\2012\THATCHER
 DWG BY: WATERPLAY SOLUTIONS CORP

DWG NAME: WATERPLAY PIPING LAYOUT
 SHEET 4/4
 PROJECT: THATCHER COMMUNITY PARK, AZ

Copyright Material
 All plans & designs at all times remain the property of Waterplay Manufacturing Inc., and cannot be used or reproduced without the written consent of Waterplay.

FOR INFORMATIONAL PURPOSES ONLY. LOCAL LANDSCAPE ARCHITECT, ENGINEER AND/OR APPROPRIATE AUTHORITIES HAVING JURISDICTION MUST COMPLETE ALL PARK LAYOUT, MECHANICAL & ELECTRICAL DESIGN PRIOR TO CONSTRUCTION.

Y COPYRIGHTED MATERIAL REPRESENTED IN THIS DOCUMENT IS NOT THE SOLE PROPERTY OF WATERPLAY SOLUTIONS CORPORATIONS AND DISTRIBUTION SHALL BE CONTROLLED.